

SPECIFICATIONS

	MAX LOAD	DIM "A" COLLAPSED	DIM "A" EXTENDED	STROKE	OIL CAPACITY	WEIGHT
HCL10002	10,644 KN/ 1196 TON	484 [19.06]	534 [21.02]	50 [1.97]	7,603 CM ³ [463.94 IN ³]	959 KG [2,115 LBS]
HCL10004		534 [21.02]	634 [24.96]	100 [3.94]	15,205 CM ³ [927.88 IN ³]	1059 KG [2,335 LBS]
HCL10006		584 [22.99]	734 [28.90]	150 [5.91]	22,808 CM ³ [1391.83 IN ³]	1160 KG [2,556 LBS]
HCL10008		634 [24.96]	834 [32.83]	200 [7.87]	30,411 CM ³ [1855.77 IN ³]	1260 KG [2,777 LBS]
HCL100010		684 [26.93]	934 [36.77]	250 [9.84]	38,013 CM ³ [2319.71 IN ³]	1360 KG [2,998 LBS]
HCL100012		734 [28.90]	1034 [40.71]	300 [11.81]	45,616 CM ³ [2783.65 IN ³]	1460 KG [3,219 LBS]

MAX PRESSURE - 700 BAR/10,150 PSI

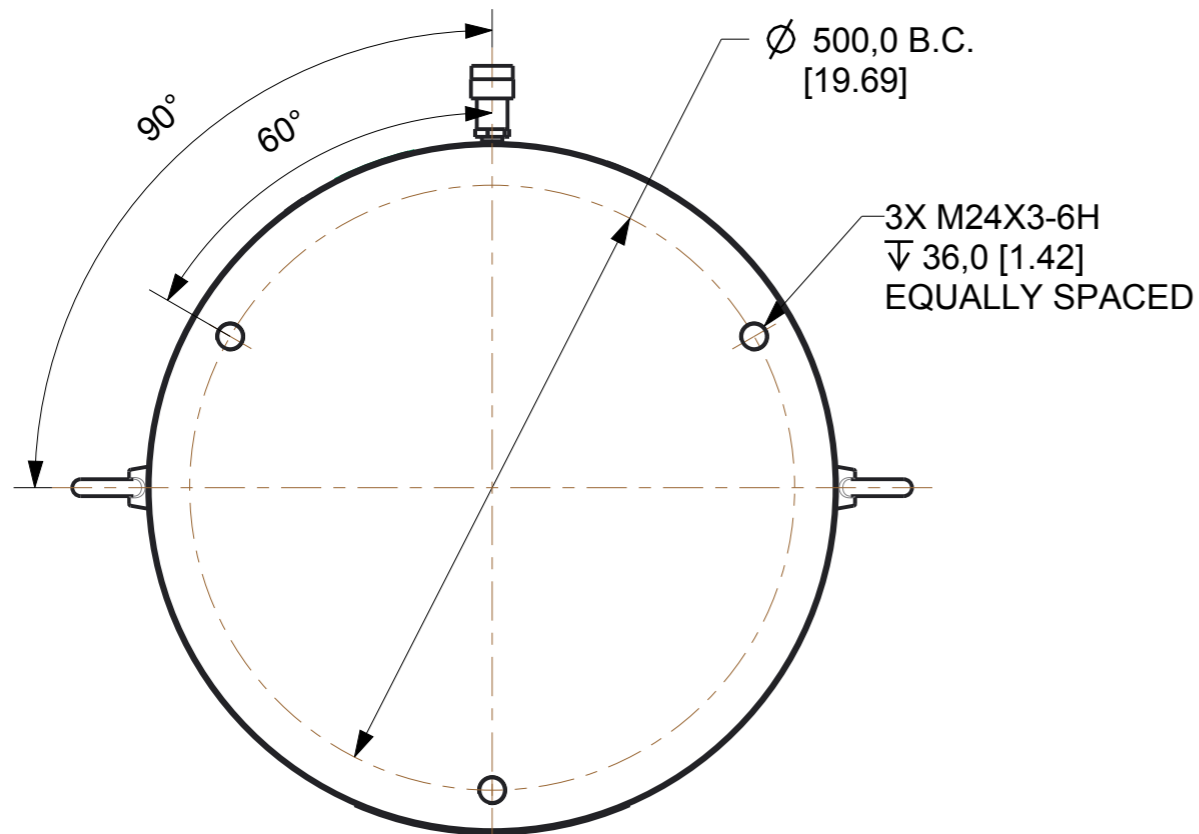

Language Code - Primary/Secondary eng/	Document Type: ID DRAWING	Description: ID SPEC HCL1000		
THIRD ANGLE PROJECTION	Technical Reference: Juan Carlos Gomez	Rev A	Date of Issue 2016DEC09	Sheet 1/1
DO NOT SCALE DRAWING	Approver: Steve Held	HCL1000ID		
Per ASME Y14.5 - 2009	Creator: John Van Roy			