

SPECIFICATIONS

	MAX LOAD	DIM "A" COLLAPSED	DIM "A" EXTENDED	STROKE	OIL CAPACITY	WEIGHT
HCL502	550 KN/ 62 TON	164 [6.46]	214 [8.43]	50 [1.97]	393 CM ³ [23.96 IN ³]	17 KG [37 LBS]
HCL504		214 [8.43]	314 [12.36]	100 [3.94]	785 CM ³ [47.93 IN ³]	22 KG [48 LBS]
HCL506		264 [10.39]	414 [16.30]	150 [5.91]	1,178 CM ³ [71.89 IN ³]	27 KG [60 LBS]
HCL508		314 [12.36]	514 [20.24]	200 [7.87]	1,571 CM ³ [95.86 IN ³]	32 KG [71 LBS]
HCL5010		364 [14.33]	614 [24.17]	250 [9.84]	1,963 CM ³ [119.82 IN ³]	38 KG [83 LBS]
HCL5012		414 [16.30]	714 [28.11]	300 [11.81]	2,356 CM ³ [143.78 IN ³]	43 KG [94 LBS]
MAX PRESSURE - 700 BAR/10,150 PSI						

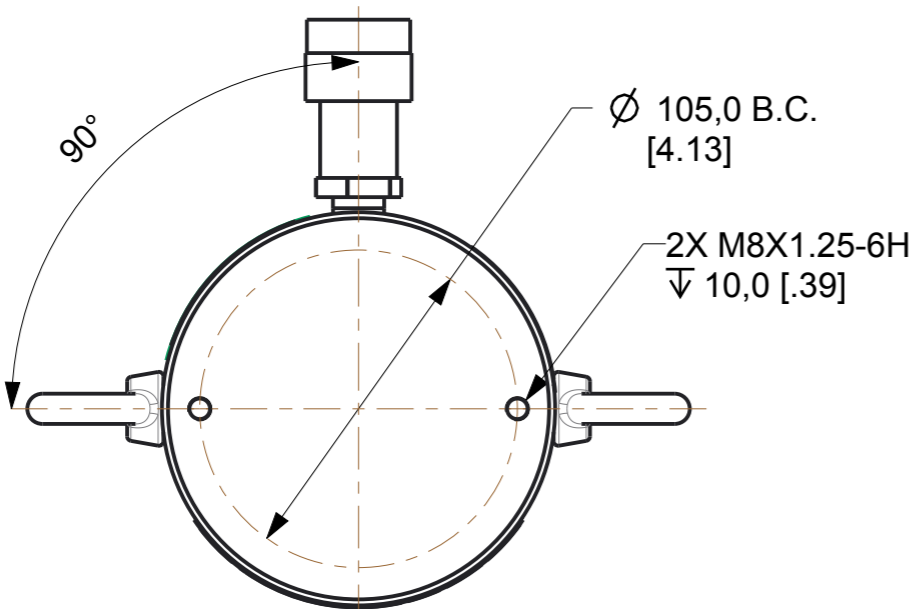

Language Code - Primary/Secondary eng/	Document Type: ID DRAWING	Description: ID SPEC HCL50			
THIRD ANGLE PROJECTION	Technical Reference: Juan Carlos Gomez	Rev A	Date of Issue 2016DEC12	HCL50ID	Sheet 1/1
DO NOT SCALE DRAWING	Approver: Steve Held				
Per ASME Y14.5 - 2009	Creator: John Van Roy	ENERPAC			