

SPECIFICATIONS							
	MAX LOAD	DIM "A" COLLAPSED	DIM "A" EXTENDED	DIM "B"	STROKE	OIL CAPACITY	WEIGHT
HCR1502	1497 KN/ 168 TON	220 [8.66]	270 [10.63]	70 [2.76]	50 [1.97]	1,069 CM ³ [65.24 IN ³]	56 KG [124 LBS]
HCR1504		270 [10.63]	370 [14.57]		100 [3.94]	2,138 CM ³ [130.48 IN ³]	67 KG [148 LBS]
HCR1506		320 [12.60]	470 [18.50]		150 [5.91]	3,207 CM ³ [195.73 IN ³]	78 KG [172 LBS]
HCR1508		397 [15.63]	597 [23.50]	90 [3.54]	200 [7.87]	4,276 CM ³ [260.97 IN ³]	95 KG [209 LBS]
HCR15010		447 [17.60]	697 [27.44]		250 [9.84]	5,346 CM ³ [326.21 IN ³]	106 KG [233 LBS]
HCR15012		497 [19.57]	797 [31.38]		300 [11.81]	6,415 CM ³ [391.45 IN ³]	116 KG [257 LBS]
MAX PRESSURE - 700 BAR/10,150 PSI							

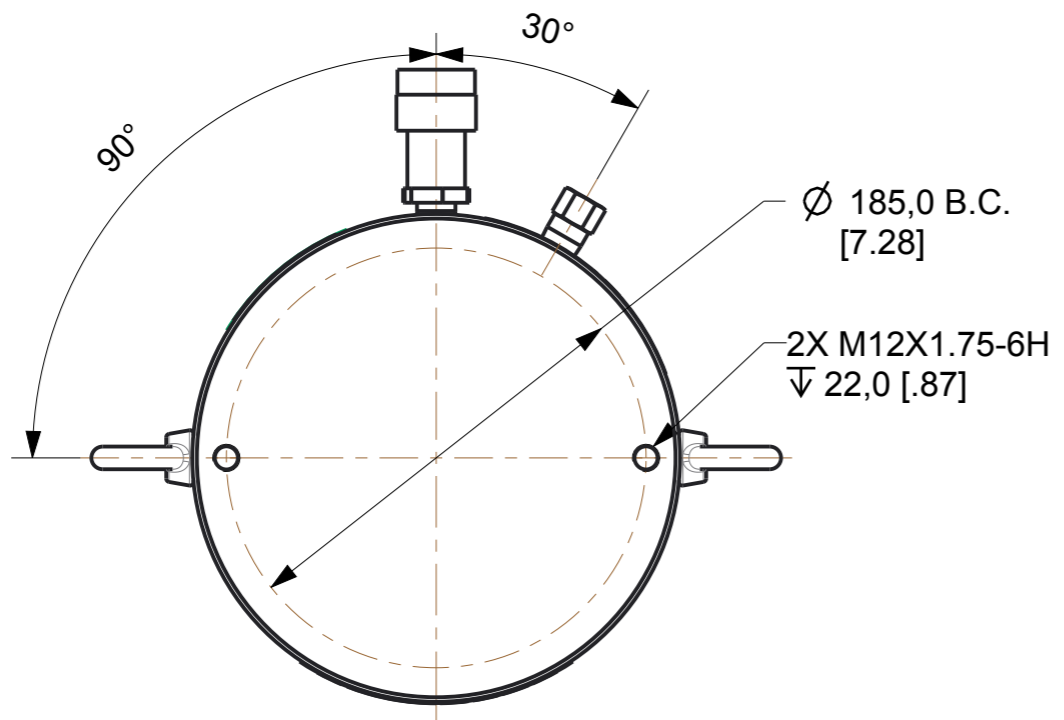

Language Code - Primary/Secondary eng/	Document Type: ID DRAWING	Description: ID SPEC HCR150		
THIRD ANGLE PROJECTION	Technical Reference: Juan Carlos Gomez	Rev A	Date of Issue 2016DEC13	Sheet 1/1
DO NOT SCALE DRAWING	Approver: Steve Held	HCR150ID		
Per ASME Y14.5 - 2009	Creator: John Van Roy	ENERPAC		