

SPECIFICATIONS							
	MAX LOAD	DIM "A" COLLAPSED	DIM "A" EXTENDED	DIM "B"	STROKE	OIL CAPACITY	WEIGHT
HCR2502	2541 KN/ 286 TON	241 [9.49]	291 [11.46]	79 [3.11]	50 [1.97]	1,815 CM <sup>3</sup> [110.77 IN <sup>3</sup> ]	107 KG [236 LBS]
HCR2504		291 [11.46]	391 [15.39]		100 [3.94]	3,631 CM <sup>3</sup> [221.55 IN <sup>3</sup> ]	127 KG [279 LBS]
HCR2506		341 [13.43]	491 [19.33]		150 [5.91]	5,446 CM <sup>3</sup> [332.32 IN <sup>3</sup> ]	146 KG [322 LBS]
HCR2508		431 [16.97]	631 [24.84]	104 [4.09]	200 [7.87]	7,261 CM <sup>3</sup> [443.09 IN <sup>3</sup> ]	184 KG [407 LBS]
HCR25010		481 [18.94]	731 [28.78]		250 [9.84]	9,076 CM <sup>3</sup> [553.87 IN <sup>3</sup> ]	207 KG [457 LBS]
HCR25012		531 [20.91]	831 [32.72]		300 [11.81]	10,892 CM <sup>3</sup> [664.64 IN <sup>3</sup> ]	227 KG [500 LBS]
MAX PRESSURE - 700 BAR/10,150 PSI							

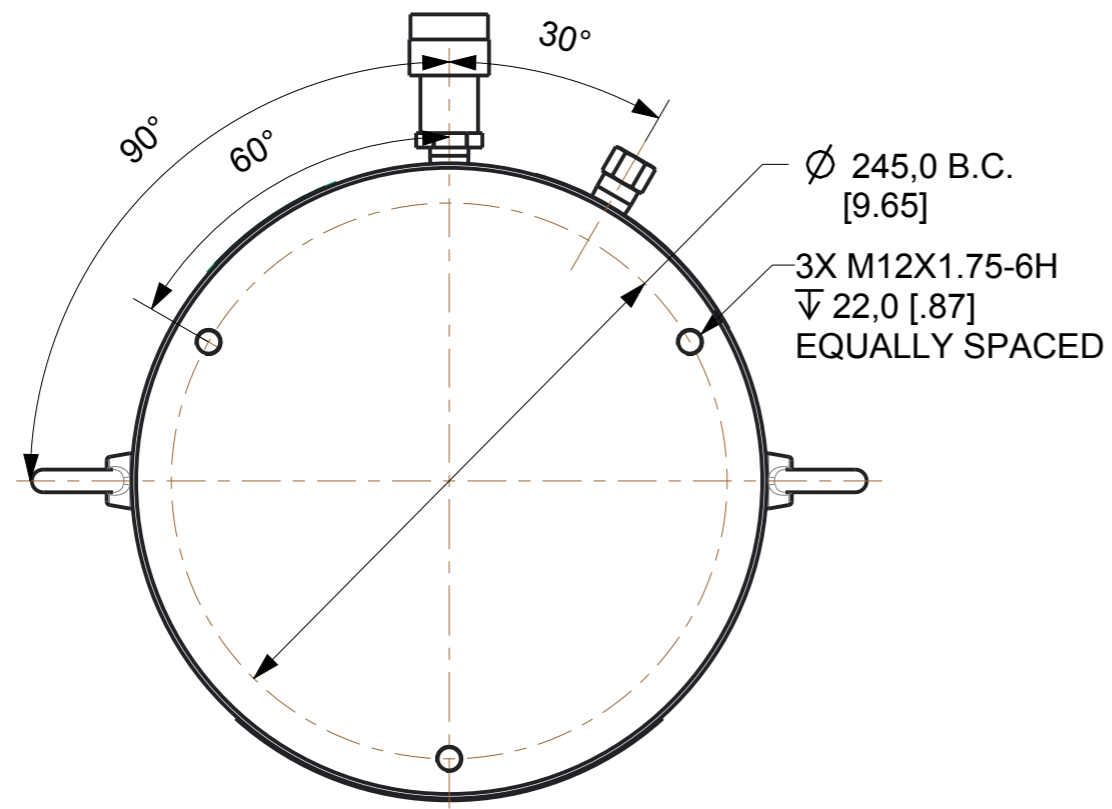

Language Code - Primary/Secondary eng/	Document Type: ID DRAWING	Description: ID SPEC HCR250		
<b>THIRD ANGLE PROJECTION</b>	Technical Reference: Juan Carlos Gomez	Rev A	Date of Issue 2016DEC13	Sheet 1/1
DO NOT SCALE DRAWING	Approver: Steve Held	HCR250ID		
Per ASME Y14.5 - 2009	Creator: John Van Roy	<b>ENERPAC</b>		