

SPECIFICATIONS

	MAX LOAD	DIM "A" COLLAPSED	DIM "A" EXTENDED	STROKE	OIL CAPACITY	WEIGHT
HCR3002	3036 KN/ 341 TON	296 [11.65]	346 [13.62]	50 [1.97]	2,169 CM ³ [132.34 IN ³]	159 KG [350 LBS]
HCR3004		346 [13.62]	446 [17.56]	100 [3.94]	4,337 CM ³ [264.68 IN ³]	183 KG [401 LBS]
HCR3006		396 [15.59]	546 [21.50]	150 [5.91]	6,506 CM ³ [397.02 IN ³]	208 KG [458 LBS]
HCR3008		446 [17.56]	646 [25.43]	200 [7.87]	8,675 CM ³ [529.36 IN ³]	232 KG [512 LBS]
HCR30010		496 [19.53]	746 [29.37]	250 [9.84]	10,843 CM ³ [661.71 IN ³]	257 KG [566 LBS]
HCR30012		546 [21.50]	846 [33.31]	300 [11.81]	13,012 CM ³ [794.05 IN ³]	281 KG [620 LBS]

MAX PRESSURE - 700 BAR/10,150 PSI

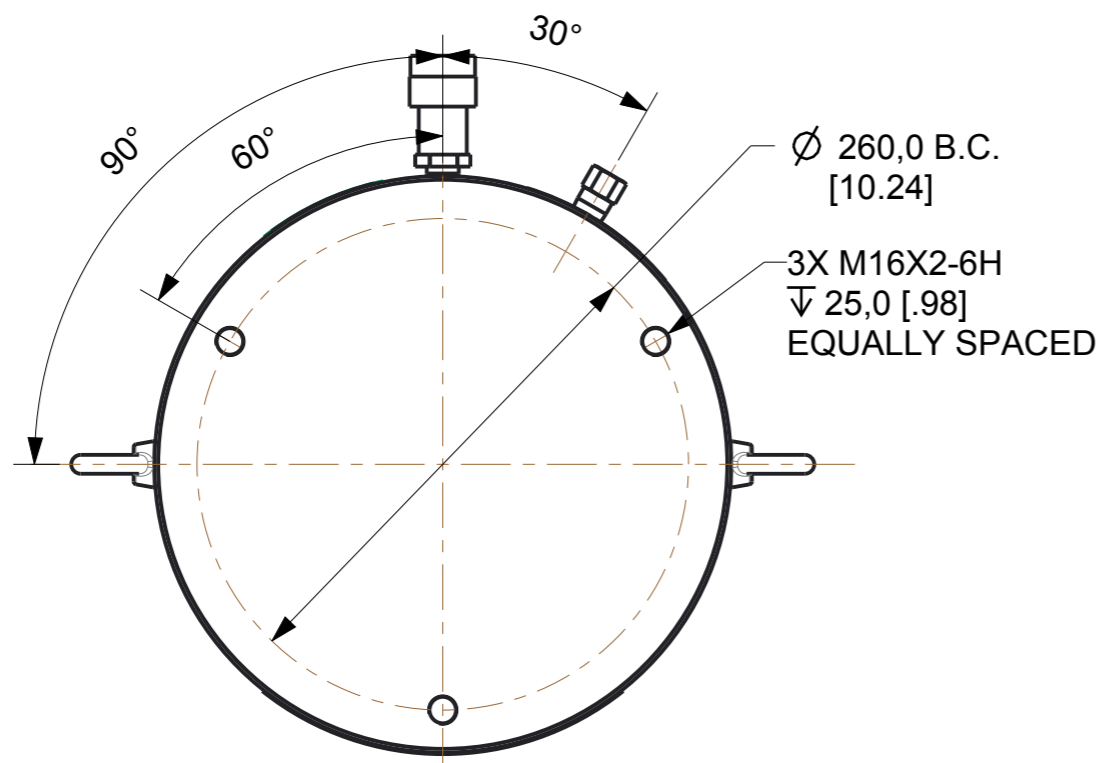

Language Code - Primary/Secondary eng/	Document Type: ID DRAWING	Description: ID SPEC HCR300		
THIRD ANGLE PROJECTION	Technical Reference: Juan Carlos Gomez	Rev A	Date of Issue 2016DEC13	Sheet 1/1
DO NOT SCALE DRAWING	Approver: Steve Held	HCR300ID		
Per ASME Y14.5 - 2009	Creator: John Van Roy			