

SPECIFICATIONS						
	MAX LOAD	DIM "A" COLLAPSED	DIM "A" EXTENDED	STROKE	OIL CAPACITY	WEIGHT
HCR4002	4008 KN/ 450 TON	321 [12.64]	371 [14.61]	50 [1.97]	2,863 CM ³ [174.70 IN ³]	227 KG [501 LBS]
HCR4004		371 [14.61]	471 [18.54]	100 [3.94]	5,726 CM ³ [349.39 IN ³]	258 KG [570 LBS]
HCR4006		421 [16.57]	571 [22.48]	150 [5.91]	8,588 CM ³ [524.09 IN ³]	289 KG [638 LBS]
HCR4008		471 [18.54]	671 [26.42]	200 [7.87]	11,451 CM ³ [698.79 IN ³]	321 KG [707 LBS]
HCR40010		521 [20.51]	771 [30.35]	250 [9.84]	14,314 CM ³ [873.49 IN ³]	352 KG [775 LBS]
HCR40012		571 [22.48]	871 [34.29]	300 [11.81]	17,177 CM ³ [1048.18 IN ³]	383 KG [843 LBS]
MAX PRESSURE - 700 BAR/10,150 PSI						

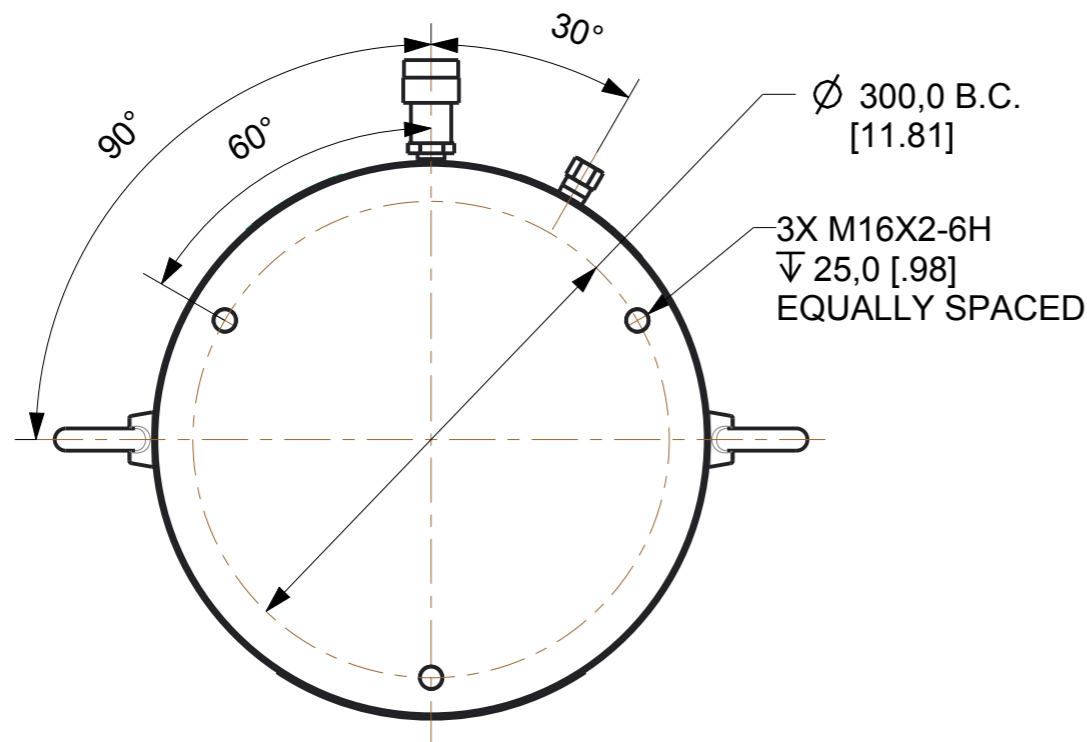

Language Code - Primary/Secondary eng/	Document Type: ID DRAWING	Description: ID SPEC HCR400			
THIRD ANGLE PROJECTION	Technical Reference: Juan Carlos Gomez	Rev A	Date of Issue 2016DEC13	HCR400ID	Sheet 1/1
DO NOT SCALE DRAWING	Approver: Steve Held				
Per ASME Y14.5 - 2009	Creator: John Van Roy	ENERPAC			