

SPECIFICATIONS

	MAX LOAD	DIM "A" COLLAPSED	DIM "A" EXTENDED	STROKE	EFEK AREA (PUSHING)	EFEK AREA PULLING	AREA RATIO	OIL CAPACITY PUSHING	OIL CAPACITY PULLING	WEIGHT	
HCRL3002	2968.8KN/ 302.6 TON	321 [12.63]	371 [14.61]	50 [1.97]	424.1 CM ² [65.74 IN ²]	35.3 CM ² [5.47 IN ²]	12.0	2121 CM ³ [129.43 IN ³]	177 CM ³ [10.78 IN ³]	179 KG [395 LBS]	
HCRL3004		371 [14.61]	471 [18.54]	100 [3.94]				12.0	4241 CM ³ [258.80 IN ³]	353 CM ³ [21.57 IN ³]	205 KG [450 LBS]
HCRL3006		421 [16.57]	571 [22.48]	150 [5.91]				12.0	6362 CM ³ [388.23 IN ³]	530 CM ³ [32.35 IN ³]	230 KG [505 LBS]
HCRL3008		496 [19.53]	696 [27.40]	200 [7.87]				12.0	8482 CM ³ [517.60 IN ³]	707 CM ³ [43.14 IN ³]	269 KG [592 LBS]
HCRL30010		546 [21.50]	796 [31.34]	250 [9.84]				12.0	10603 CM ³ [647.03 IN ³]	884 CM ³ [53.92 IN ³]	294 KG [647 LBS]
HCRL30012		596 [23.46]	896 [35.28]	300 [11.81]				12.0	12723 CM ³ [776.41 IN ³]	1060 CM ³ [64.70 IN ³]	319 KG [702 LBS]

MAX PRESSURE - 700 BAR/10,150 PSI

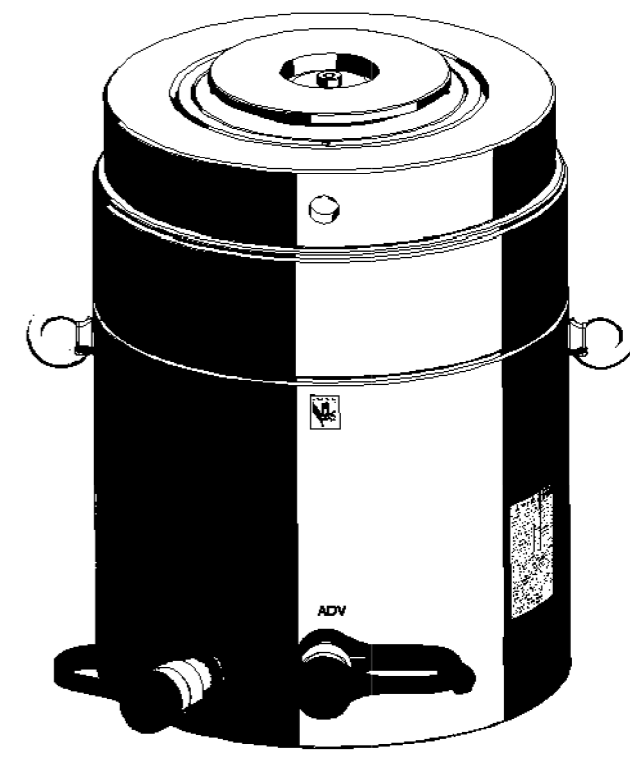

SCALE 1:5

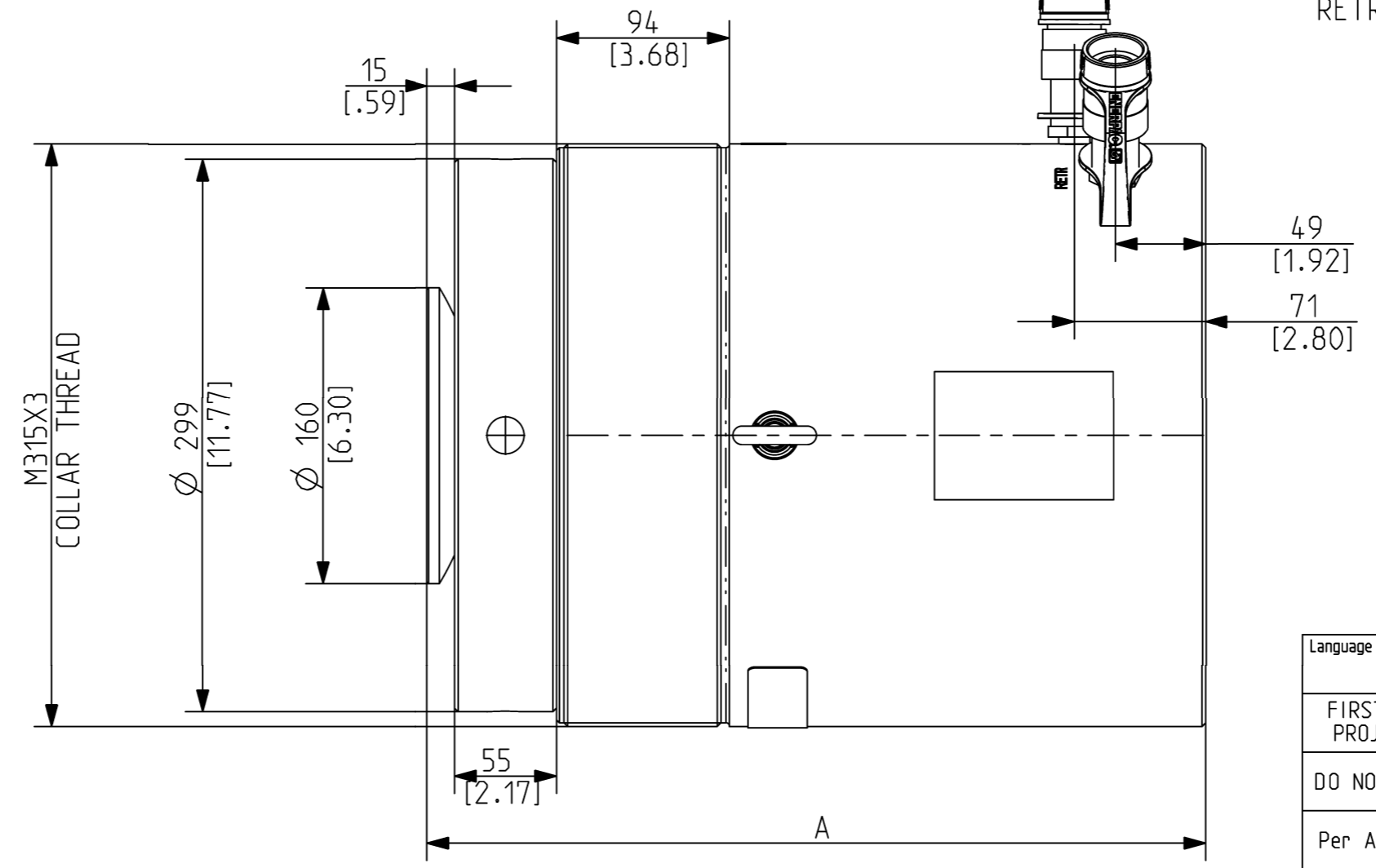
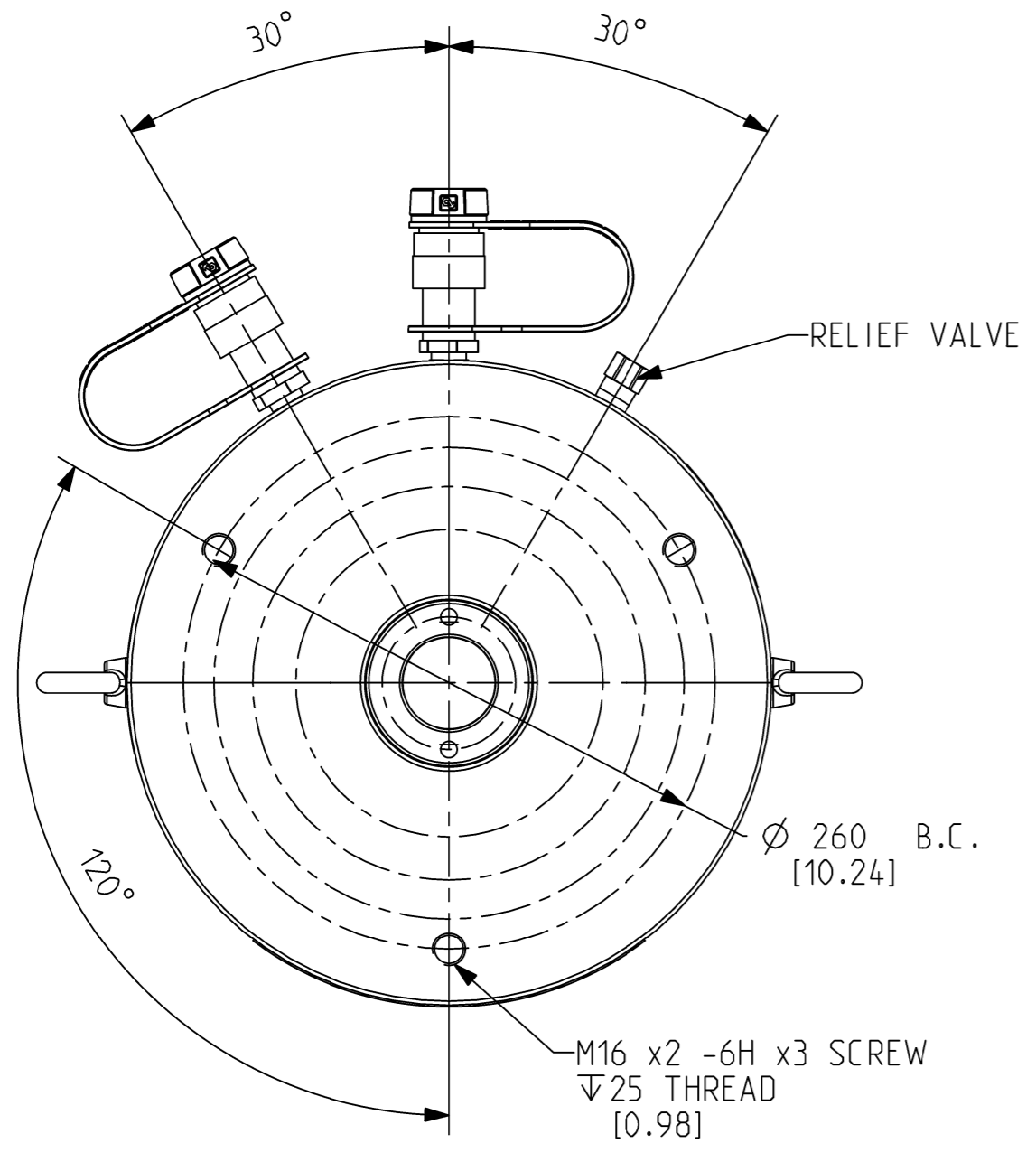
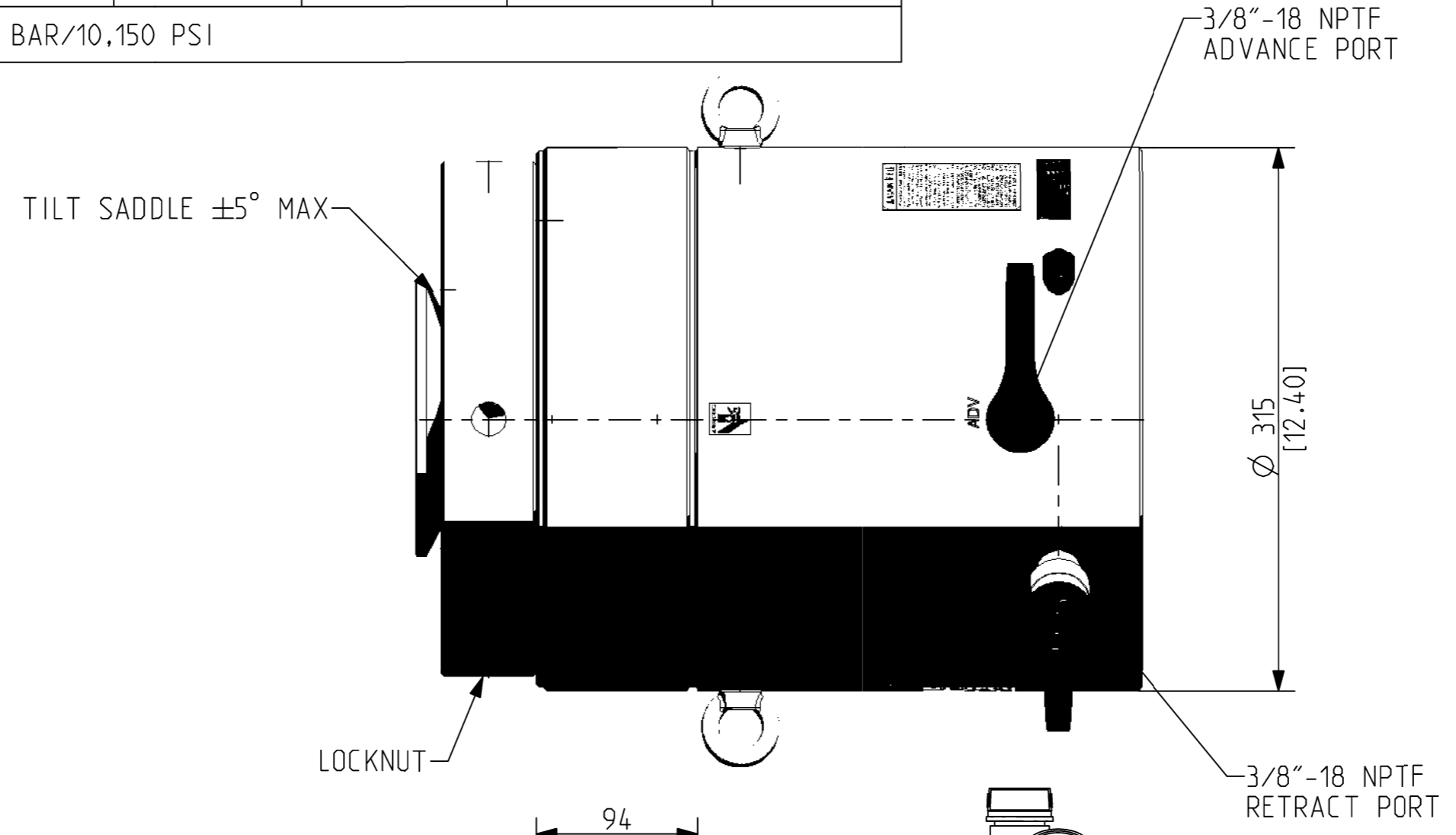

Language Code - Primary/Secondary eng/	Document Type: Assembly	Description: ID SPEC HCRL300		
FIRST ANGLE PROJECTION	Technical Reference: Juan Carlos Gomez	Rev F	Date of Issue 2018MAR22	Sheet 1/1
DO NOT SCALE DRAWING	Approver: Juan Carlos Gomez	Creator: Miguel Montero		
Per ASME Y14.5 - 2009				