

INCHES
MILLIMETERS

REVISION HISTORY		
REV	ECM #	DATE/INITIAL
B	807049	07-29-08/TJA

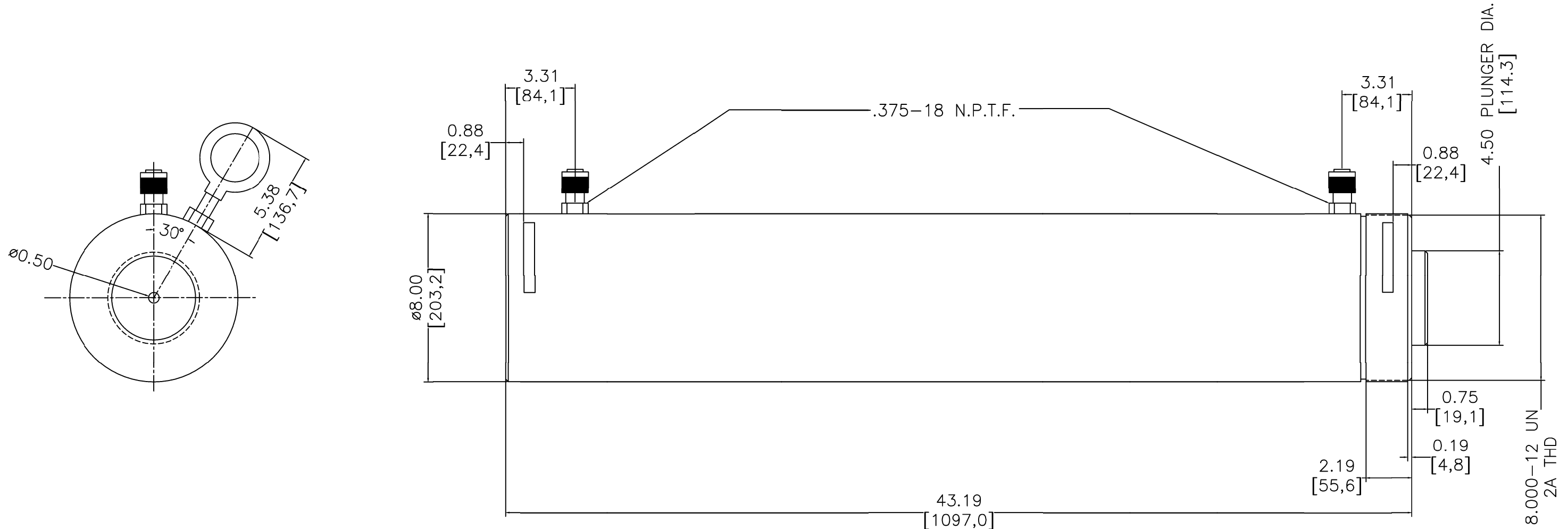

COLLAPSED HEIGHT: 43.94 IN. [1116,1MM]
EXTENDED HEIGHT: 76.06 [1931,9MM]
EFFECTIVE AREA: PUSH-30.68IN². (197,9CM²) PULL-14.78IN². (95,4CM²)
OIL CAPACITY: PUSH-985IN³. (16,144.2CM³) PULL-475IN³. (7785.3CM³)
INT. PRESS RATED CAP.: PUSH-9,778 PSI. (67,409.5kN/m²) PULL-10,000PSI. (68,940kN/m²)
FORCE PUSH-300,000 LBS.(136,080KG) PULL-147,800 LBS. (67,042.1 kg)
STROKE: 32.12 IN. [815.8MM]
WEIGHT: 614 LBS. (287.5 kg)
BORE DIA: 6.25

THIRD ANGLE PROJECTION FINISH UNLESS SPECIFIED Ray [Ra] μm IN [mm]	UNLESS OTHERWISE SPECIFIED DIMENSIONS ARE IN INCHES TOLERANCES ARE: DECIMALS METRIC .X ? .02 X. ?0.5mm .XX ? .01 X.X ?0.25mm .XXX ? .005 X.XX ?0.1mm ANGLES ?1°	DO NOT SCALE DRAWING		
		APPROVALS	DATE	
MATERIAL:		DRAWN BY: TJA	07-29-08	SIZE B DWG NO. ID1637
FINISH:		ENGR: DD	07-29-08	
TREATMENT:		THIS PRINT AND INFORMATION HEREIN IS CONFIDENTIAL AND PROPRIETARY AND IS THE PROPERTY OF ENERPAC. IT IS NOT TO BE COPIED OR REPRODUCED WITHOUT WRITTEN PERMISSION.		SCALE NTS DWG FORMAT AutoCAD SHEET 1 OF 1